



Frog Pond

A precut friendly pattern featuring...

WATER'S EDGE

by Natural Born Quilter Brett Lewis



Quilt Size: 48 1/2" x 56 1/2"



Frog Pond

Finished Project Size: 48 ½" x 56 ½"

Technique: Traditional Piecing

Skill Level: Beginner

Seam allowance ¼"

Tools: Rotary Cutter, Cutting Mat, ruler, pins, drawing utensil

RST: Right sides together

HST: Half Square Triangle

Fabric Requirements:

- Water's Edge Tile Pack (TWATER42-10)
- Horsetail 26716-76 (green) - ½ yard (Binding)
- Leap Frog (navy) 26711-49 - 3 ¼ yard for Backing

Cutting and Piecing Directions

Using a tile pack of 42 x 10" squares, randomly pair up 2 prints. Pairing prints with high contrast (light and dark) will have greatest effect for the pattern.

Step 1

Draw a diagonal line on the wrong side of half of the 10" squares.

Layer 2 Tile fabrics right side together, sew a scant ¼" seam allowance on either side of the marked line (see diagram).

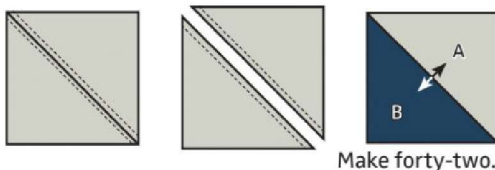

Cut along the marked line to form two HSTs and press seams to the darker fabric. You will now have 42 HST.

by Brett Lewis of Natural Born Quilter

Step 2

Draw a diagonal line in the opposite direction of the seam on the wrong side of half of the HST. With RST, now layer two HST units together, and sew a scant ¼" seam allowance on either side of the marked line (see diagram).

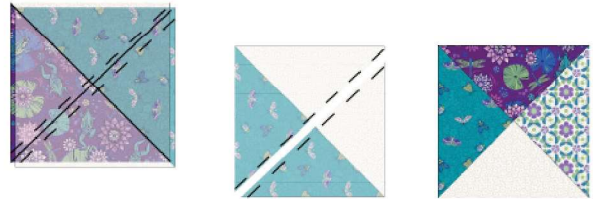

Cut along the marked line to form the "lily pad" block. Trim all blocks to measure 8 ½" x 8 ½".

Assemble the Top

Using a design wall, randomly orient your blocks in rows (6 blocks per row, 7 rows total). Sew blocks together using a ¼" seam allowance, piecing each row. Once all rows are pieced, sew the rows together, pressing the rows in alternating directions ensures you can nest your seams together. Use pins when sewing your rows together, noting where seams intersect and nest.

Finishing the Quilt: Quilt and bind as desired.

Visit me at: www.naturalbornquilter.com

Contact me at: brettnbq@gmail.com

Follow me on Instagram or Facebook and post your progress or finished projects using: #watersedgefabric #frogpondquilt #naturalbornquilter